

**ATTACHMENT 30B - TELECOMMUNICATION SERVICE:  
A MAP SHOWING THE LOCATION OF THE NEAREST  
TELECOMMUNICATION INFRASTRUCTURE SERVING THE  
INDUSTRIAL PARK**

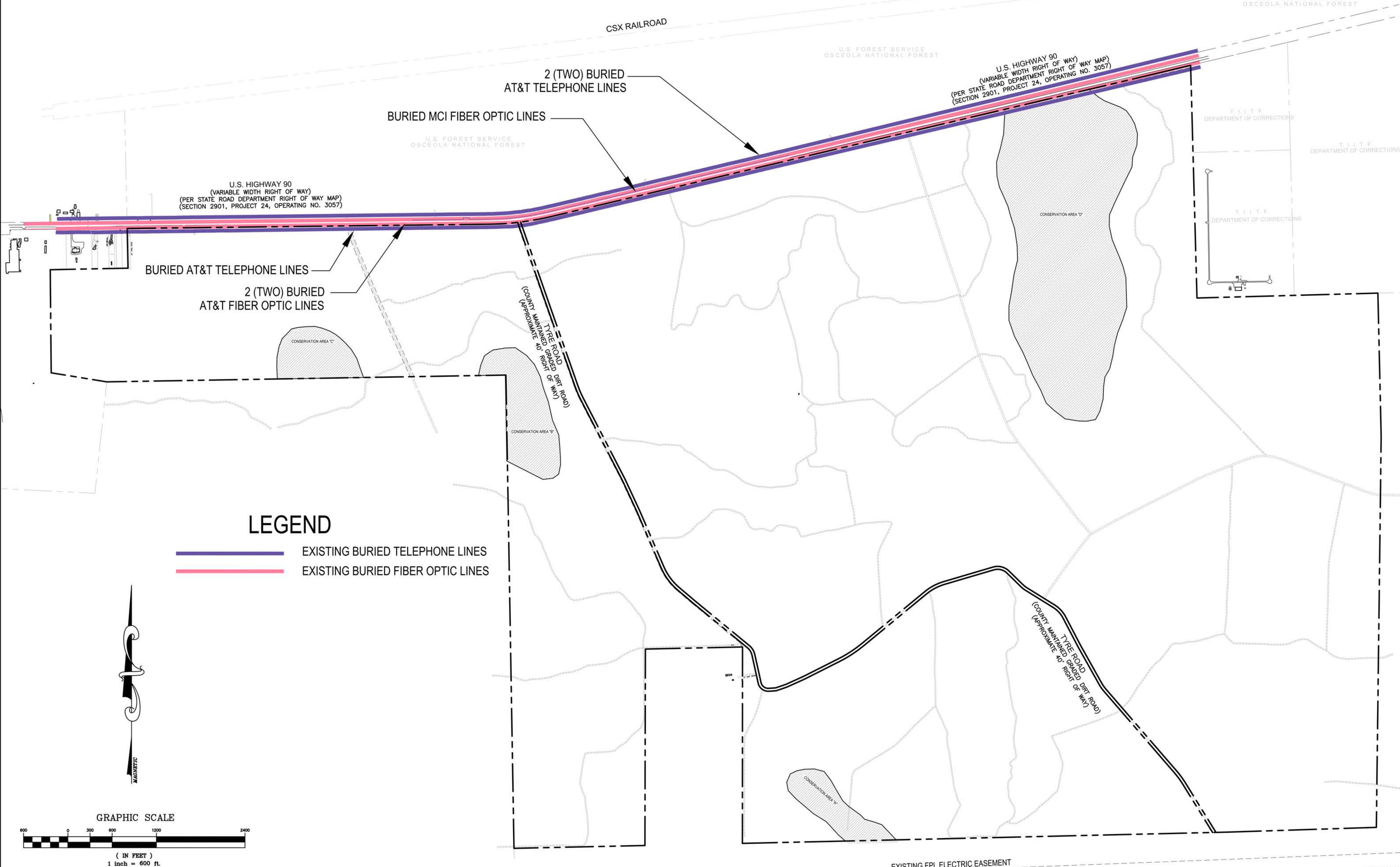

**LEGEND**

- EXISTING BURIED TELEPHONE LINES
- EXISTING BURIED FIBER OPTIC LINES

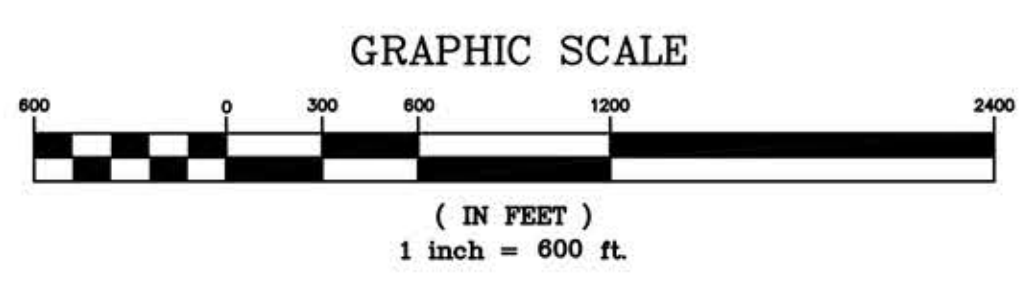

**Moore Bass**  
CONSULTING  
TALLAHASSEE  
DESTIN  
ATLANTA  
324 Industrial Boulevard  
McDonough, Georgia 30253  
(770) 914-9394 (Office)  
(770) 914-9588 (Fax)  
www.moorebass.com

PROJECT NAME	NORTH FLORIDA INTERMODAL PARK COLUMBIA COUNTY, FLORIDA
CLIENT NAME	PLUM CREEK P.O. BOX 357700 GAINESVILLE, FL 32635-7700

REVISIONS	



UTILITY EXHIBIT.dwg	
ARCHIVE	
DATE	8/6/12
FILE #	
CONTRACT #	
DRAWN BY	SDM

The Drawings, Specifications and other documents prepared by Moore Bass Consulting, Inc. (MBC) for this Project are instruments of MB for use solely with respect to this Project and, unless otherwise provided, MB shall be deemed the author of these documents and shall retain all common law, statutory and other reserved rights, including the copyright.

SEAL

SHEET TITLE  
**UTILITY MAP -  
TELECOMMUNICATION  
SERVICE**

SHEET  
**30-B**

G:\projects\Columbia County\McClain Sweeney\UTILITY EXHIBIT.dwg, 30-B, smoores, Aug 08, 2012, 2:19:21pm